



Hennepin County Transportation Department

ADDENDUM

**TO PLANS, SPECIFICATIONS AND SPECIAL PROVISIONS FOR
LAKE STREET (CSAH 3) BRIDGE IMPROVEMENTS
HENNEPIN COUNTY TRANSPORTATION DEPARTMENT**

(To be opened Tuesday, **June 13, 2017** at 2:00 P.M.)

ADDENDUM NO. 3

**CSAH 3/CSAH 35; C.P. 1659
S.A.P. 062-635-007**

NOTICE TO ALL BIDDERS:

This Addendum shall be attached to the Contract Documents and shall be included as part of said Contract Documents. Items herein shall take precedence over any clauses which they modify in the Contract Documents or portions of plans which they modify or supplement.

PLANS

See Attachment A - Revised Plan Sheets for the following modifications:

1. Plan Sheet No. 2 STATEMENT OF ESTIMATED QUANTITIES– **Remove and Replace** with attached Sheet 2.
 - Change to SEQ.
2. Plan Sheet No. P2 – Remove and Replace with attached Sheet P2.
 - Change to cable notation.
3. Plan Sheet No. E1 – Remove and Replace with attached Sheet E1.
 - Change to cable notation.

JJT:jj
June 8, 2017

Receipt of this addendum must be acknowledged in accordance with the provisions of 1210 of the specifications.

Attachment A – Revised Plan Sheets

STATEMENT OF ESTIMATED QUANTITIES

NOTE	ITEM NO.	ITEM DESCRIPTION	UNIT	(P)	TOTAL	HENNEPIN COUNTY HENN CO. PROJ 1659	RAMSEY COUNTY PARTICIPATING S.A.P. 062-635-007
					EST.	EST.	EST.
	2021.501	MOBILIZATION	LUMP SUM		1		
(1)	2013.601	LIFELINE SAFETY SYSTEM	LUMP SUM		1	0.5	0.5
(1)	2013.601	REMOVE LIFELINE SAFETY SYSTEM	LUMP SUM		1	0.5	0.5
	2100.604	MASONRY RESTORATION	SQ YD		69	34.5	34.5
(2)	2104.503	REMOVE CONCRETE SIDEWALK	SQ FT		80	40	40
(3)	2104.509	REMOVE CONCRETE STEPS	EACH		43	21.5	21.5
(4)	2104.509	REMOVE BENCH	EACH		8	4	4
	2104.603	SAWING CONCRETE WALK	LIN FT		327	163.5	163.5
(5)	2104.618	REMOVE STONE PAVERS	SQ FT		1152	576	576
(6), (18)	2411.507	CONCRETE STEP	EACH		43	21.5	21.5
(7), (8), (18)	2433.603	RECONSTRUCT EXPANSION JOINT TYPE 9	LIN FT		62	31	31
(7), (9), (18)	2433.603	RECONSTRUCT EXPANSION JOINT TYPE A	LIN FT		124	62	62
(7), (10), (18)	2433.603	RECONSTRUCT EXPANSION JOINT TYPE 4	LIN FT		176	88	88
(11)	2433.603	RECONSTRUCT EXPANSION JOINT TYPE SPECIAL	LIN FT		52	26	26
(12)	2502.603	CLEAN PIPE DRAIN	LIN FT		12	6	6
(13), (18)	2521.618	CONCRETE WALK	SQ FT		1222	611	611
(14)	2540.602	WOOD BENCH	EACH		8	4	4
(15)	2540.603	JOINT SEALANT	LIN FT		162	81	81
(16)	2540.618	STONE PAVERS	SQ FT		72	36	36
(17)	2563.601	TRAFFIC CONTROL	LUMP SUM		1	0.5	0.5

1 ITEMS LISTED BELOW ARE FOR ALTERNATE BID:
 -2013.601 "LIFELINE SAFETY SYSTEM"
 -2013.601 "REMOVE LIFELINE SAFETY SYSTEM"

REVISION		
DATE	DESCRIPTION	APPROVED BY
6-7-2017	CHANGE SEQ	JDE

1

1

NOTES:

- (1) SEE SPECIFICATIONS
- (2) REPLACE BRIDGE APPROACH SIDEWALK PANEL IN NORTHWEST ADJACENT TO STRIP SEAL.
- (3) REMOVAL OF STAIR TREAD AND CONCRETE NOSE OF STEP. QUANTITY OF CONCRETE VARIES PER STEP. MAY INCLUDE REMOVAL OF #4 REINFORCEMENT IN NOSE.
- (4) REMOVE WOOD AND ANY DAMAGED BOLTS OR TIE BARS FROM BENCHES. METAL SUPPROT BRACKETS AND CONCRETE BASES ARE TO REMAIN IN PLACE.
- (5) QUANTITY INCLUDED 1142 SQ. FT. FOR ALCOVES AND PLAZAS ON BRIDGE DECK; 10 SQ. FT. FOR SLOPE PAVING AT WEST ABUTMENT.
- (6) REPLACEMENT OF CONCRETE STAIR NOSE AND TREAD. REPLACEMENT MAY INCLUDE #4 REBAR.
- (7) ITEM INCLUDES SAWCUTTING CONCRETE, REMOVAL OF OLD JOINT AND COMPONENTS, NEW TRANSVERSE REINFORCEMENT, NEW JOINT SYSTEM COMPONENTS AND NEW CONCRETE.
- (8) 9 IN. MODULAR JOINT AT SPANDREL 11.
- (9) 6 IN. MODULAR JOINTS AT PIER 4 AND PIER 6.
- (10) 4 IN. STRIP SEAL EXPANSION JOINTS AT WEST AND EAST ABUTMENTS.
- (11) REPLACE NEOPRENE SEAL UNDER WALKS AT MODULAR JOINTS. 18 FT. AT TYPE 9 AND 34 FT. AT TYPE A (PIERS 4 AND 6). SEE TABLE ON SHEET 14 FOR WIDTHS.
- (12) CLEAN OUT 6 DRAINS OUTLETS IN SOUTHEAST RETAINING WALL. ESTIMATE OF AN AVERAGE LENGTH OF 2 FT. PER OUTLET.
- (13) 1142 SQ. FT. FOR ALCOVES AND PLAZAS ON BRIDGE DECK AND 80 SQ. FT. OF 4 IN. WALK FOR PANEL REMOVED IN NORTHWEST SIDEWALK. ANY BIT FELT REQUIRED AROUND LIGHT PYLONS OR BENCH PEDISTALS IS INCIDENTAL.
- (14) THERE ARE 4 PLAZAS AND 2 ALCOVES. EACH PLAZA HAS 1 BENCH (60 LIN. FT. OF LUMBER PER BENCH) AND EACH ALCOVE HAS 2 BENCHES (49 LIN. FT. OF LUMBER PER BENCH). SEE SHEET 25 FOR LUMBER SIZES AND LOCATIONS. ITEM INCLUDES REPLACEMENT OF ANY BOLTS, SCREWS AND TIE BARS USED TO ATTACH NEW BENCH TO EXISTING BRACKETS.
- (15) REPLACE JOINT SEALANT IN VERTICAL JOINTS IN SOUTHEAST RETAINING WALL AND TOP OF SLOPE PAVING AT WEST ABUTMENT: RETAINING WALL - 10 JOINTS WITH AN AVERAGE HEIGHT OF 7 FT., WEST ABUTMENT - 92 FT ACROSS THE FULL WIDTH OF THE ABUTMENT.
- (16) 3½ IN. STONE PAVERS AT THE WEST ABUTMENT.
- (17) CONTRACTOR TO PROVIDE TRAFFIC PLANS. MUST BE SUBMITTED FOR REVIEW BY ENGINEER PRIOR TO ANY INSTALLATION.
- (18) ALL REINFORCEMENT TO BE EPOXY COATED.



I HEREBY CERTIFY THAT THIS PLAN WAS PREPARED BY ME OR UNDER MY DIRECT SUPERVISION AND THAT I AM A DULY LICENSED PROFESSIONAL ENGINEER UNDER THE LAWS OF THE STATE OF MINNESOTA.

JACOB Z. BRONDER, PROFESSIONAL ENGINEER
 41848 5/5/2017
 LICENSE NO. DATE

DESIGNED BY: J. BRONDER
 CHECKED BY: J. EKOLA
 DRAWN BY: P. HAGSTROM
 CHECKED BY: T. MATTONEN

STATEMENT OF ESTIMATED QUANTITIES

CSAH 03 / HENNEPIN COUNTY PROJECT 1659
 BRIDGE 62082 S.A.P. 062-635-007

SHEET
 2
 25

This is an electronically signed and sealed drawing or document in .pdf format. If in a different electronic format or printed on paper, it is a COPY.

Larson Engineering, Inc.
 9624 Labore Road
 White Bear Lake, MN 55110-5100
 651.481.9120 Fax: 651.481.9201
 www.larsonengr.com © 2014 LEI

Lake Street Bridge Tieback Anchor Layout
 Minneapolis, MN
 Hennepin County Property Services

I hereby certify that this plan, specifications or report was prepared by me or under my direct supervision and that I am a duly licensed Professional Engineer under the laws of the state of Minnesota.

Print Name: Thomas J. Renick
 Signature: *Thomas J. Renick*
 Date: 21 Apr 2015 Reg. No. 25310

No.	Date	Description

Project#: 13141412
 Drawn by: BRP/TR
 Checked by: _____
 Sheet Title:
Enlarged Plan

Sheet: **P2** of 6

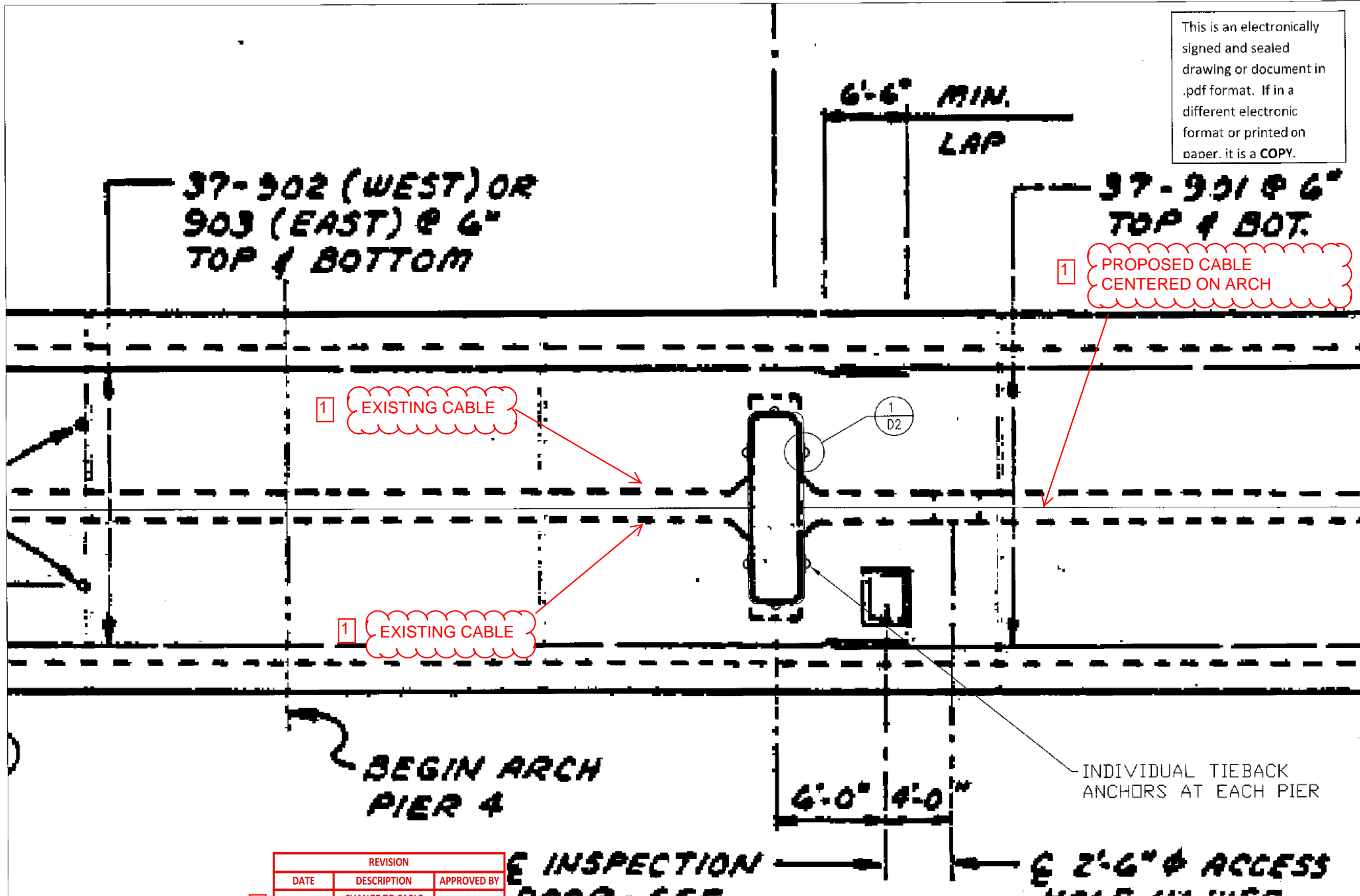

REVISION		
DATE	DESCRIPTION	APPROVED BY
6-7-2017	CHANGE TO CABLE NOTATION	JDE

1 ENLARGED PLAN
 P2
 3/16" = 1'-0"

**Lake Street Bridge
 Tieback Anchor Layout**
 Minneapolis, MN
 Hennepin County

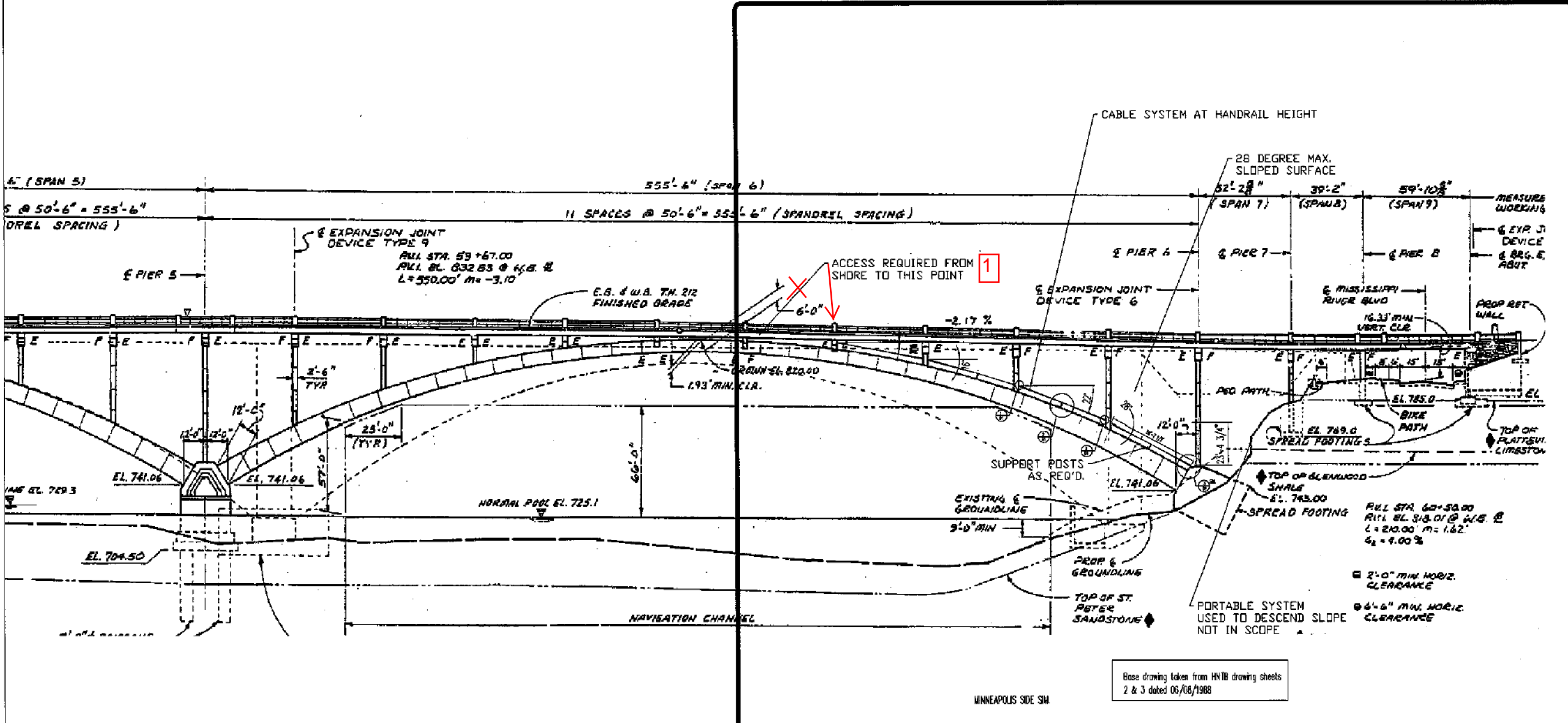

2
E1 **ELEVATION-ST. PAUL SIDE**
 NOT TO SCALE

REVISION		
DATE	DESCRIPTION	APPROVED BY
6-7-2017	CHANGE TO CABLE NOTATION	JDE

This is an electronically signed and sealed drawing or document in .pdf format. If in a different electronic format or printed on paper, it is a COPY.

I hereby certify that this plan, specifications or report was prepared by me or under my direct supervision and that I am a duly licensed Professional Engineer under the laws of the state of Minnesota.

Print Name **Thomas J. Renick**
 Signature *Thomas J. Renick*
 Date 21 Apr 2015 Reg. No. 25310

No.	Date	Description

Project#: 13141412
 Drawn by: BRP/TR
 Checked by:
 Sheet Title:
Elevation

E1